

GHK Stainless Steel Folding Handle

Features

- 90 degree folding handle
- Handle clicks into open and closed position
- Oval profile for optimum grip

Parts Included

- Toothed washer size 6 (SUS)
- Hexagon nut for M6 (SUS)

| No. | Part Name | Material | Finish |
|-----|-----------|-----------------------------|----------|
| ① | Handle | Stainless Steel (SUS304) | Polished |
| ② | Base | | |

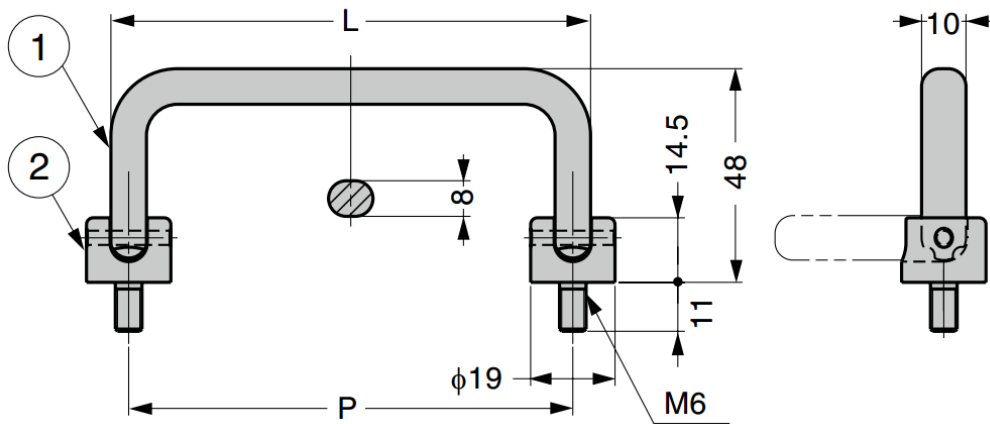
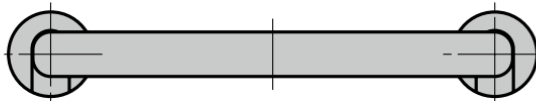

| Part No. | L | P | Load Capacity | |
|----------|-----|-----|---------------|-------|
| GHK-80 | 88 | 80 | 490 N | 50 kg |
| GHK-100 | 108 | 100 | | |
| GHK-120 | 128 | 120 | | |